

SPECIFICATIONS

Stage	2				
Gear Ratio	i	15:1	25:1	30:1	50:1
Rated Output Torque	Nm	138	138	102	150
Moment of Inertia	g-cm ²	750	400	750	400
Torsional Stiffness	Nm/arcmin	8			
Max output torque	Nm	3 times of Rated Outout Torque			
Max radial load	N	2450			
Max axial load	N	2200			
Max input speed	RPM	8000			
Backlash	acrmin	≤12 (standard) ≤6 (precision)			
Noise level	dB(A)	≤62			
Operating temp.	°C	-25~90			
Lifetime	Hrs	20000			
Efficiency	%	≥92			
Protection Level		IP64			
Mounting Position		Any			
Weight	Kg	4.5			
Tightening Clamp Torque	N.m/in-lbs	7.94/70.30			

NOTES:

Unless Otherwise Specified
 All Angles ±0.5°
 Break All Edges 0.2mm-0.8mm
 Decimals .X ±0.2/ .XX ±0.05
 T.I.R 0.05 0.05 0.05

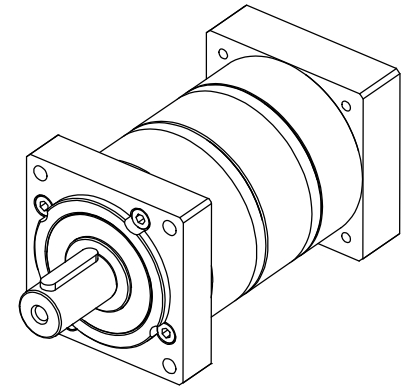

Unit: mm	Technical reference Scale: 1:1.5	Approved by	
		Document type	Document status
		Title MPS90-XXX-20	
		Rev.	Date of issue
		Sheet	

GEARBOX